

PRODUCT OPERATION MANUAL

0508

2016.12.20

CATALOGUE

I. Safety Instruction	2
II. Products Instruction	3
III. Operation Instruction.....	4
IV. Maintenance Instructions	5
V. Storage Instructions.....	5

I. **Safety Instruction**

1. Before the installation, please be sure to read the manual

Operation and maintenance personnel must be carefully reading and familiar with manual before the installation, operation, and maintenance attachments, improper installation, operation, and maintenance attachments will likely lead to serious injury or death.

2. Read and understand all safety statement

- ※ Reading familiar with all safety mark and security statement before working ;
- ※ Operation comply with all occupational safety regulations, local laws and regulations and other professional guidelines;
- ※ Assembly, maintenance, operation follow the good work habits.

3. Be familiar with attachments

- ※ Familiar with and understand before operation machine performance and parameter;
- ※ Be carefully inspection machine before working , be sure that all devices debugging when normal before we can carry out the homework;
- ※ Ensure that the machine is installed firmly, change may have damaged parts, ensure that all hydraulic joint and hydraulic devices connected firmly;
- ※ Ensure that all safety mark stick in the correct position and mark font clear.

4. Wear protective clothing

Operation to wear safety clothing, wear protective glasses or mask to prevent operation is splash content cause harm to human body.

5. Don't in any form of machine modified

6. Safe maintenance of machine

- ※ Maintenance tools must be down to level the ground, far away from the traffic and other dangerous places. If you need rises machine maintenance, must use solid objects can cushion for leaning on stability;
- ※ Maintenance should be according to the operating procedures require the use of special tools. If there is no special tools, can use a similar tool, in ordinary tools can make the parts have this or that kind of damage, it is necessary to use a special tool.

7. Safe operation of a machine

- ※ A drunk or drug response of cases do not operate;
- ※ If anyone enter the homework risk area, should immediately stop machine operation, stop operation, please will machine flat on the ground.

II. Product Description

1、 Product structure description:

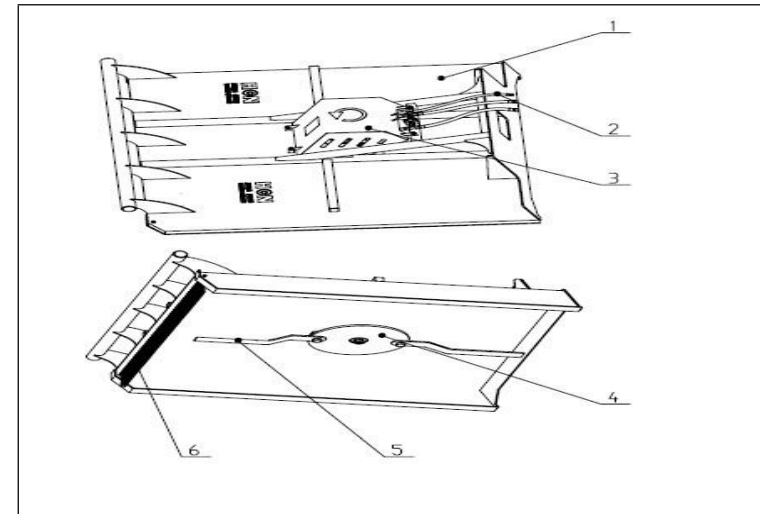

1-Frame 2-Hydraulic System 3-Cover 4-Cutter Disk 5-Cutter
6-Chains

2、 Technical performance:

Model	050845	050860	050872
Overall Length (mm)	1850	1938	2344
Overall Width (mm)	1456	1831	2033
Overall Height (mm)	575	593	555
Overall Weight (kg)	330	480	635
Cutting Width (mm)	1140	1524	1828
Working Pressure (Mpa)	14-21	16-21	16-21
Min. cutting height (mm)	50	50	50
Cutter quantity	2	2	2
Working flow (L/Min)	60-80	60-80	75-90
Suitable machine	Skidsteer /small loader/mini excavator		

III. Operation Instructions

Please operating as following steps:

1. Host machine connect with grass mower hitch frame part, and fixed by pin.
2. Grass mower inlet, outlet and drain pipes connect with host machine inlet, outlet and drain pipes.
3. Drive the host machine and adjust parallelism and height between grass mower and ground, after adjustment, drive host machine to supply oil to mower motor to make it work (Note: grass mower is counterclockwise rotation, so please pay attention to the direction of oil).
4. After working, lay the mower flat on the ground or platform, pull out pin shaft, drive host machine from grass mower, clean and add lubricating oil into grass mower to wait next work.

IV. Maintenance Instructions

1. Thoroughly clean all the dirt, dirt and grease on the surface.
2. Check visible worn signals, replace the worn or broken parts, not to influence the next use.
3. Check the connecting bolts, and tighten up the loosen bolt and nuts.

4. Check all the hydraulic hoses and motor need be covered with seals.
5. Smear all the outer parts of the cylinders with oils.
6. Lubricate all the lubricated points with butter.
7. Replace damaged or obscure labels.
8. Repaint if found the surface of the attachment is scratched to avoid rust.

V. Storage Instructions

1. During stocking, put equipment on wood plate, do not directly put on ground.
2. Should be stored in a dry and safe place, exposed will shorten the service life of equipment.
3. All hydraulic pipeline and oil mouth close up with caps.
4. All the leakage of cylinder rod grease.
5. Regular maintenance on equipment.

I. Product Breakdown Structure

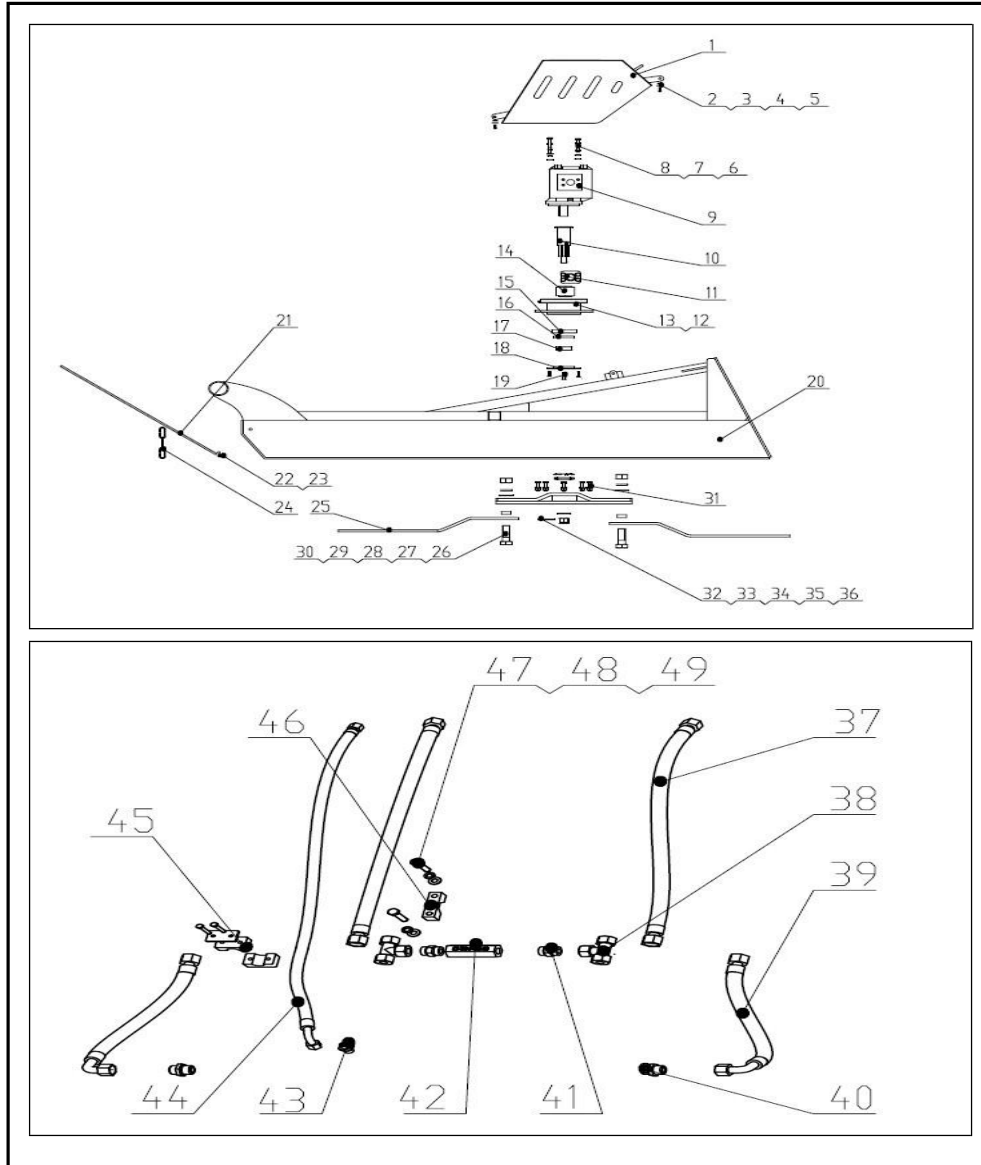

II. Product Parts List

No.	Part No.	Name	Qty	Note
1	0508-01	Cover	1	
2	0508-02	Bolt M8*25	4	GB/T 5783-2000
3	0508-03	Flat Gasket D8	6	GB/T 5783-2000
4	0508-04	Spring Washer D8	6	GB/T 93-1987
5	0508-05	Nut M 8	6	GB/T 6170-2000
6	0508-06	Bolt M12*45	12	GB/T 5783-2000
7	0508-07	Spring Washer D12	12	GB/T 93-1987
8	0508-08	Flat Gasket D12	12	GB/T 97.3-2000
9	0508-09	Motor	1	
10	0508-10	Spline Shaft	1	
11	0508-11	Joint	2	
12	0508-12	Bearing Block	1	
13	0508-13	Grease Fitting	1	
14	0508-14	Bearing	1	
15	0508-15	Outside Block	1	
16	0508-16	Seal Ring	1	
17	0508-17	Inner Block	1	
18	0508-18	End Cap	1	
19	0508-19	Bolt M8*25	8	GB/T 70.3-2000
20	0508-20	Frame	1	
21	0508-21	Chain Axis	1	
22	0508-22	Nut M8	8	GB/T 6170-2000
23	0508-23	Flat Gasket D8		GB/T 5783-2000
24	0508-24	Chain	62	
25	0508-25	Blade	2	
26	0508-26	Bolt M30*90	2	GB/T 5783-2000

27	0508 -27	Axle Sleeve	2	
28	0508 -28	Flat Gasket D30	2	GB/T 97. 3-2000
29	0508 -29	Spring Washer D30	2	GB/T 93-1987
30	0508 -30	Nut M30	1	GB/T 6170-2000
31	0508 -31	Nut M12	6	GB/T 6170-2000
32	0508 -32	Cotter	1	GB/T91-2000
33	0508 -33	Hexagon Slotted Nut M24	1	GB/T 9458-1988
34	0508 -34	Spacer	1	
35	0508 -35	Round Nut	1	GB/812-1988
36	0508 -36	Lock Washer	2	GB/T858-1988
37	0508 -37	Tube A	2	
38	0508 -38	Tee Joint	2	
39	0508 -39	Tube B	2	
40	0508-40	Joint A	2	
41	0508-41	Joint B	2	
42	0508-42	One-way Valve	1	
43	0508-43	Joint C	2	
44	0508-44	Tube C	1	
45	0508-45	Pipe Clamp A	1	
46	0508-46	Pipe Clamp B	1	
47	0508-47	Bolt M10*45	1	GB/T 5783-2000
48	0508-48	Flat Gasket D10	1	GB/T 97. 3-2000
49	0508 -49	Spring Washer D10	1	GB/T 93-1987