



HCN ATTAMCHMENTS CONTENT YOUR NEED

PRODUCT USER'S MANUAL

Our contact information:

Address: No.1 Huake Road, Xuzhou Economic
and Technological Development Zone,
Xuzhou, China

Postcode: 221004

Tel: 0516-66881280 66881281

Fax: 0516-66881272

Website: <http://www.hcn-atta.com>

Product model: 0524A60 and 0524B60 Hedgerow

Trimmer

Preparation date: 2024.6.24

XUZHOU HCN ATTACHMENT MANUFACTURE CO., LTD.

Warm reminder:

Please read the manual carefully before installing and using the product.

CATALOGUE

- 1. Safety Instruction 2
- 2. Products Instruction 3
- 3. Operation Instruction 4
- 4. Maintenance Instructions 6
- 5. Storage Instructions 6

One. A safety note

1. Always read this manual carefully before installation

Operation and maintenance personnel must carefully read and be familiar with the manual before installing, operating and maintaining the machine. Incorrect installation, operation and maintenance of the machine may lead to serious injury or death.

2. Read and understand all of the safety statements

Read and familiarize yourself with all safety markers and safety statements before work;

Compliance with all occupational safety regulations, local laws and regulations and other professional guidelines;
Follow good working habits during assembly, maintenance and operation.

3. Familiar with machines and tools

Be familiar with and understand the performance and parameters of the machine before operation;

Before operation to carefully check the machines and tools, when all the devices are adjusted debugging can be operated;

Ensure that the machine is installed firmly installed, replace parts that may be damaged, and ensure that all hydraulic joints and hydraulic devices are firmly connected;

Ensure that all safety markers are placed in the correct position and that the logo and font are clear.

4. Wear protective clothing

Wear warning clothes according to the relevant requirements, so as to get off the car to check, warning reminder, especially the implementation of the highway green belt pruning work.

5. Do not modify the machine in any form

6. Safe to repair machines

⌘ During maintenance, the machine must be lowered to horizontal ground and kept away from traffic and other dangerous places; if the machine is needed for maintenance, it must be secured with solid objects.

Special tools shall be used during maintenance according to the operating procedures. If there are no special tools, some similar tools can be used, and whenever any ordinary tools can cause the parts of this or that damage, the special tools must be used.

7. Safe to operate the machine

Do not operate if you are drunk or taking medication;

If someone enters the operation danger area, the operation of the machine should be stopped immediately. When the operation stops, please put the machine flat on the ground;

Two. product description

Product structure description:

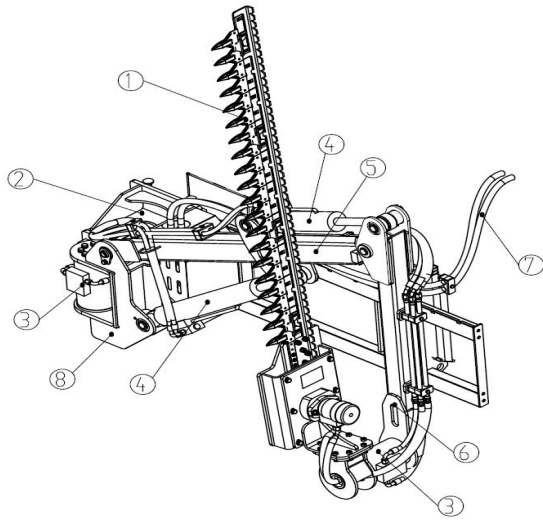

① - -cutter; ② - -base; ③ - -swing cylinder; ④ - -telescopic cylinder;
 ⑤ - -Large arm; ⑥ - -small arm; ⑦ - -hydraulic line; ⑧ - -rotary support.

6. If it is not used for a long time, please coat the sliding surface of the slide block and the knife holder with anti-rust oil to prevent rust.

※ Please pay attention to the protection of the product nameplate, the product nameplate is incomplete or lost will not be guaranteed.

Three. operation declaration

The company production hedge trimmer suitable for excavator, sliding loader and forklift, mainly used for highway green belts, municipal gardens, urban greening, tea garden, cutting, river weeds beautification, pruning engineering, can meet the adjustment into flat, trapezoidal, tower pruning forms, with high work efficiency, pruning range, pruning forms diversification, etc

1. Precautions

- 1) Before use, according to the limit block on the spot welding equipment of the main engine;
- 2) The hydraulic oil pipe is smoothly connected without obvious bending;
- 3) Check all the bolts and nuts without any loosening;
- 4) Adjust the flow of the machine system according to the technical requirements to avoid excessive flow damage to the motor, and run the cutter to check whether it is smooth and sound;
- 5) Adjust the extension arm to the required Angle size, and pay attention to the position of the cutter during the adjustment of the arm to prevent the cutter from touching the ground or other obstacles and damaging the cutter;

6) Pay attention to avoid obstacles or other large-diameter plants in the green belt in the process of pruning;

7) When pruning the branches, pay attention to control the speed and the diameter of the branches. Excessive speed and exceeding the requirements of this product will cause damage to the cutter.

8) Before the equipment starts the work, all personnel should be far away from the equipment and in a safe position.

2. Operation steps

1) Move the rear hanger plate to the corresponding position according to the working direction.

2) The product hanger is connected with the main boots to ensure secure installation. Connect with the oil inlet and outlet and drain pipes of the main engine; place the pipes in a position without affecting the work without obvious bending phenomenon.

3) At the idle state of the host, adjust the hedge working Angle by using the control box:

① Adjust the angle of the main engine slider so that the hedge rear hanger is perpendicular to the ground; ② adjust the 180 deflection cylinder to turn to the working position; ③ adjust the opening and

closing degree of the upper arm and forearm to determine the working height; ④ adjust the 360 deflection cylinder to turn to the appropriate working direction.

4) In the process of advancing, ensure the 300mm spacing between the side and the green belt of the product and the main engine.

5) When the pruning depth is large, start within the 500mm range, trim to the required depth for several times, and then advance according to the required depth at one time.

6) The forward speed is determined according to the pruning situation.

7) After use, the cutter shall stop working, use the control box to adjust the deflection cylinder and the forearm, and the main power switch is closed and placed in the drying shed to avoid touching the ground; grease the butter port, bearing and grease.

Four. maintenance instruction

1. During the maintenance and maintenance of the equipment, close the power source, so that the cutter is in a static state;
2. Check the wear degree of the blade, replace the new blade seriously, wipe the new blade clean with the blade that does not need to be replaced

and apply anti-rust oil;

3. Check all bolts, nuts and screws, especially on the blade protector, and tighten all loose nuts, caps and screws;

4. Inject grease into the connecting block and blade of each point pin shaft and cutter regularly, and it is recommended to use once per month before and after and when not;

5. Replace the damaged or blurred labels;

6. If the paint surface falls off or damages, please repair the paint in time to prevent rust;

2. Technical performance indicators:

0524A60 hedge trimmer technical parameters	
model	Standard standard blade-reciprocating
Total width (transport size) (mm)	2300
Total height (transport size) (mm)	1400
Total length (transport size) (mm)	1100
Trim Width (mm)	1500

Maximum trim branch size (mm)	20
Flat shear range (mm)	Vertical (from the bottom of the implement frame): -670~2890
	Horizontal (from the right of the machine frame): 1280-4380
Range of vertical shear (mm)	Range of vertical shear (mm)
	Vertical (from the bottom of the implement frame): -2700~4940
Horizontal (from the right of the machine frame): 480~2350	Horizontal (from the right of the machine frame): 480~2350
Weight (including pendant) (Kg)	Weight (including pendant) (Kg)
305	305
Working Pressure (MPa)	Working Pressure (MPa)
16	16

Work flow rate (L / Min)	Work flow rate (L / Min)
60	60
working voltage (V)	working voltage (V)

Five. Storage instructions

1. When entering the warehouse, put the machine flat on the tray, and prohibit direct contact with the ground;
2. It should be stored in a dry and safe place, and the exposure will shorten the life of the equipment;
3. Inject grease to the pin shaft and the connecting block of the cutter, wipe the blade clean and apply anti-rust oil;
4. The hydraulic pipeline is closed with the oil port cap;
- 5 Maintain and maintain this machine regularly.



HCN ATTAMCHMENTS CONTENT YOUR NEED

Our contact information:

Address: No.1 Huake Road, Xuzhou Economic
and Technological Development Zone,
Xuzhou, China

Postcode: 221004

Tel: 0516-66881280 66881281

Fax: 0516-66881272

Website: <http://www.hcn-atta.com>



PRODUCT USER'S MANUAL

Product model: 0524B60 Hedgerow Trimmer

Preparation date: 2024.6.25

XUZHOU HCN ATTACHMENT MANUFACTURE CO., LTD.

Warm reminder:

Please read the manual carefully before installing and using the product.

CATALOGUE

1. Safety Instruction	2
2. Products Instruction	3
3. Operation Instruction	4
4. Maintenance Instructions	6
5. Storage Instructions	6

One. Safety instructions

1. Always read this manual carefully before installation

Operation and maintenance personnel must carefully read and be familiar with the manual before installing, operating and maintaining the machine and tool. Incorrect installation, operation and maintenance of the machine may lead to serious injury or death.

2. Read and understand all of the safety statements

Read and familiarize yourself with all safety markers and safety statements before work;

Compliance with all occupational safety regulations, local laws and regulations and other professional guidelines;

Follow good working habits during assembly, maintenance and operation.

3. Be familiar with the machine and tool

Be familiar with and understand the performance and parameters of the machine before operation;

Before operation to carefully check the machines and tools, when all the devices are adjusted debugging can be operated;

Ensure that the machine is installed firmly installed, replace parts that may be damaged, and ensure that all hydraulic joints and hydraulic devices are firmly connected;

Ensure that all safety markers are placed in the correct position and that the logo and font are clear.

4. Wear protective clothing

Wear warning clothes according to the relevant requirements, so as to get off the car to check, warning reminder, especially the implementation of the highway green belt pruning work.

5. Do not modify the machine in any form

6. Safe maintenance machines

During maintenance, the machine must be lowered to the horizontal ground, away from traffic and other dangerous places; if the machine needs to be raised for maintenance, it must be secured with solid objects.

Special tools shall be used during maintenance according to the operating procedures. If there are no special tools, some similar tools can be used, and whenever any ordinary tools can cause the parts of this or that damage, the special tools must be used.

6. Safe operation of the machine

7 Do not operate if you are drunk or taking medication;

※ If someone enters the operation danger area, the operation of the machine should be stopped immediately. When the operation, please put the machine flat on the ground;

Tow. Product Structure Description

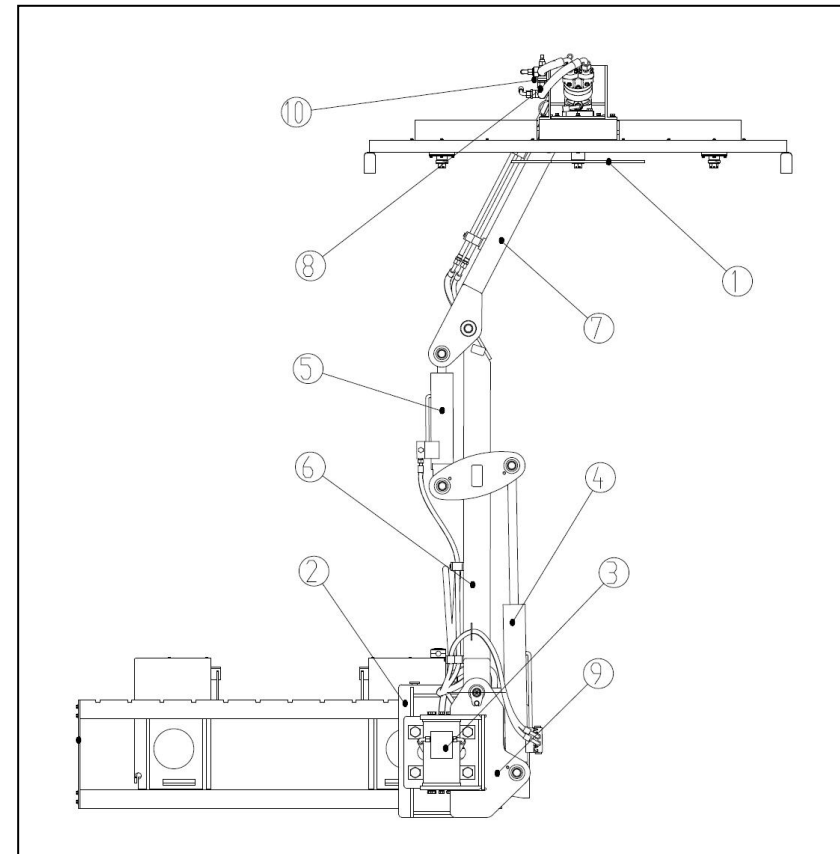

① -Cutting; ② -base; ③ -support swing cylinder; ④ -arm telescopic cylinder;

⑤ -Small arm telescopic cylinder; ⑥ -large arm; ⑦ -small arm; ⑧ -hydraulic system;

⑨ -rotary support; ⑩ -cutter swing cylinder

Technical performance indicators:

0524B60 hedge trimmer technical parameters	
model	Standard with knife head-swing knife
Total width (transport size) (mm)	1790
Total height (transport size) (mm)	1900
Total length (transport size) (mm)	1100
Trim Width (mm)	1500
Maximum trim branch size (mm)	30
Flat shear range (mm)	Vertical (away from the bottom of the implement frame):-820~2380
Range of vertical shear (mm)	Horizontal (from the right side of the implement frame):-130~2930

Theoretical weight (including pendant) (Kg) model	Vertical (away from the bottom of the implement frame): -1250~3470
	Horizontal (from the right side of the implement frame): 1000~2930
Total width (transport size) (mm)	310
Working Pressure (MPa)	16
Work flow rate (L / Min)	60
working voltage (V)	12
Maximum trim speed (km/h)	3
Best direction of use	Horizontal pruning
Adapted models	Sliding loader

Three. operation declaration

The company production hedge trimmer suitable for excavator, sliding loader and forklift, mainly used for highway green belts, municipal gardens, urban greening, tea garden, cutting, river weeds beautification, pruning engineering, can meet the adjustment into flat, trapezoidal, tower pruning forms, with high work efficiency, pruning range, pruning forms diversification, etc.

1. Precautions

- 1) Before use, according to the limit block on the spot welding equipment of the main engine;
- 2) The hydraulic oil pipe is smoothly connected without obvious bending;
- 3) Check all the bolts and nuts without any loosening;
- 4) Adjust the flow of the machine system according to the technical requirements to avoid excessive flow damage to the motor, and run the cutter to check whether it is smooth and sound;
- 5) Adjust the extension arm to the required Angle size, and pay attention to the position of the cutter during the adjustment of the arm to prevent the cutter from touching the ground or other obstacles and damaging the cutter;

6) Pay attention to avoid obstacles or other large-diameter plants in the green belt in the process of pruning;

7) When pruning the branches, pay attention to control the speed and the diameter of the branches. Excessive speed and exceeding the requirements of this product will cause damage to the cutter.

8) Before the equipment starts the work, all personnel should be far away from the equipment and in a safe position.

2. Operation steps

- 1) Move the rear hanger plate to the corresponding position according to the working direction.
- 2) The product hanger is connected with the mainframe sliding boots to ensure a secure installation. Connect with the oil inlet and drain pipes of the main engine; place the pipes in a position without affecting the work without obvious bending phenomenon.
- 3) At the idle state of the host, adjust the hedge working Angle by using the control box:

As shown in the figure, the first is the self-locking button to controls the main power switch of the button box; the second is the self-locking

button to control the operation of the cutter; the third is the three-gear self-reset knob to controls the left and right offset of the support; the third is the third-gear reset knob to controls the expansion and lifting of the large arm; the third-gear self-reset knob to controls the left-right swing of the cutter; the sixth is the third-gear reset knob to control the expansion and lifting of the small arm.

① Adjust the angle of the main engine slider so that the hedge rear hanger is perpendicular to the ground; ② adjust the 180 deflection cylinder to turn to the working position; ③ adjust the opening and closing degree of the upper arm and forearm to determine the working height; ④ adjust the 360 deflection cylinder to turn to the appropriate working direction.

4) In the process of advancing, ensure the 300mm spacing between the side and the green belt of the product and the main engine.

5) When the pruning depth is large, start within the 500mm range, trim to the required depth for several times, and then advance according to the required depth at one time.

6) The forward speed is determined according to the pruning situation.

7) After use, the cutter shall stop working, use the control box to adjust

the deflection cylinder and the main power switch are closed and placed in the drying shed to avoid touching the ground; grease the butter port, bearing and apply grease.

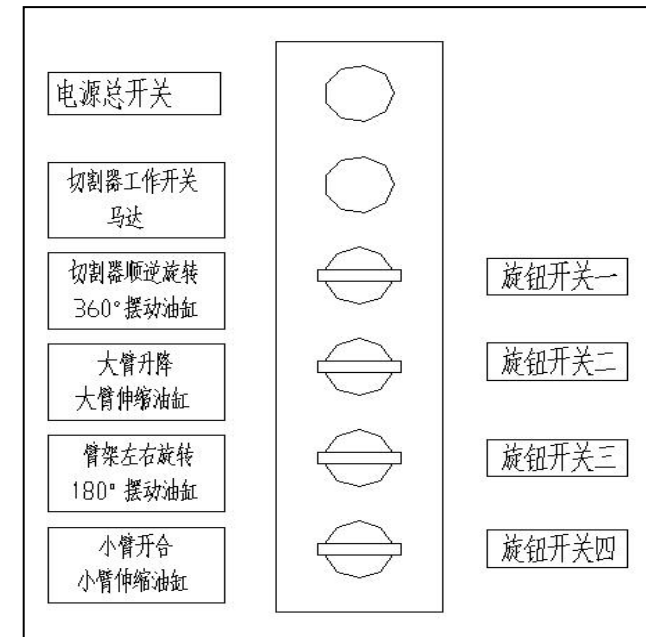

control box

Four. maintenance instruction

1. During the maintenance and maintenance of the equipment, close the

power source, so that the cutter is in a static state;

2. Check the wear degree of the blade, replace the new blade seriously, wipe the new blade clean with the blade that does not need to be replaced and apply anti-rust oil;
3. Check all bolts, nuts and screws, especially on the blade protector, and tighten all loose nuts, caps and screws;
4. Inject grease into the connecting block and blade of each point pin shaft and cutter regularly, and it is recommended to use once per month before and after and when not used;
5. Replace the damaged or blurred labels;
6. If the paint surface falls off or damages, please repair the paint in time to prevent rust;
7. If it is not used for a long time, please coat the sliding surface of the slide block and the knife holder with anti-rust oil to prevent rust.

Please pay attention to the protection of the product nameplate, the product nameplate is incomplete or lost will not be guaranteed.

Five. Storage instructions

When entering the warehouse, put the machine flat on the tray, and

prohibit direct contact with the ground;

2. It should be stored in a dry and safe place, and the exposure will shorten the life of the equipment;
3. Inject grease to the pin shaft and the connecting block of the cutter, wipe the blade clean and apply anti-rust oil;
4. The hydraulic pipeline is closed with the oil port cap;
- 5 Maintain and maintain this machine regularly.