



HCN ATTAMCHMENTS CONTENT YOUR NEED

PRODUCT OPERATION MANUAL

Our contact information:

Address: No.1 Huake Road, Xuzhou Economic and
Technological Development Zone,
Xuzhou, China

Postcode: 221004

Tel: 0516-66881280 66881281

Fax: 0516-66881272

Website: <http://www.hcn-atta.com>

product model: 0206I series cold planer

Preparation date: 2024.06

XUZHOU HCN ATTACHMENT MANUFACTURE CO., LTD.

CATALOGUE

1. Safety Instruction	2
2. Products Instruction	3
3. Operation Instruction	5
4. Maintenance Instructions	8
5. Storage Instructions	9

1. Safety instructions

- (1) Please read the instructions carefully before using this equipment to avoid construction Personal injury;
- (2) Know the production or working capacity of the equipment, Size and operation steps;
- (3) Pay attention to the splash caused by the operation process of the equipment, and at the same time Wear protective glasses, helmet and face mask;
- (4) Hydraulic oil under high pressure, if the leakage will cause great damage to personnel To death, operators should stay away from possible leaks Oil pipe joint;
- (5) Do not modify the equipment arbitrarily, so as not to cause performance, safety and reliability The reduction of;
- (6) The working environment requirements of the equipment: flat ground, wide vision;
- (7) Make sure that the equipment you use is free of oil at its steps and handrails class;
- (8) Operators shall ensure that they is not within the scope of equipment operation anybody;
- (9) When the equipment is running, the operator shall not leave;
- (10) When starting the work, the work area should be isolated to avoid miscellaneous people Personnel or livestock, etc. close, so as not to be milling out of the debris caused by strict Heavy damage;
- (11) Do not run this device on a steep uphill slope to avoid tipping turn over;
- (12) Operators shall not operate the machine while intoxicated, otherwise it will Reduce the judgment ability of danger signals;
- (13) When the operator leaves the main machine, the milling machine should be lowered To the ground and then close the host engine and remove the key;

(14) Check all fasteners and ensure that there is no loosening phenomenon
Damaged parts should be replaced promptly; check all warning marks
Whether the card is clean and clear, if it is damaged, replace it in time.

product description

(1) Description of the product structure

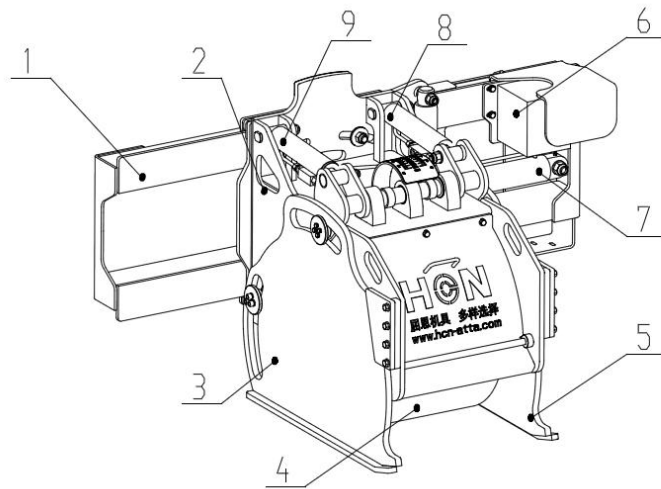

- (1) Side shift frame (2) main frame (3) right support plate
- (4) milling drum(5) Left floating plate (6) hydraulic valve set
- (7) side moving cylinder (8) left depth cylinder
- (9) right depth cylinder

Main technical parameters of the product

Model	020612 I	020618 I	020624 I	020640 I
length (mm)	1215	1215	1215	1100
width (mm)	1760	1760	1760	1760
height (mm)	970	970	970	880
Milling width(mm)	300	450	600	1000
Milling depth (mm)	0-110	0-170	0-170	0-130
Maximum lateral shift distance (mm)	510	510	510	420
angle of inclination (°)	± 8	± 8	± 8	± 8
Work flow (L/min)	80-110	120-150	120-170	120-200

Maximum allowable pressure(MPa)	21	21	21	21
Operating voltage (V) (optional)	DC12/24	DC12/24	DC12/24	DC12/24
Theoretical weight (including pendant) (Kg)	850	950	1100	1150
Choose accessories	1、 Optional blade (asphalt blade and concrete blade) 2、 spray system			
Adapted models	Skid steer loader (with large flow output)			

operation declaration

1. Equipment ruler

Depth scale: The milling depth can be viewed by either pointer; the pointer indicate separately.

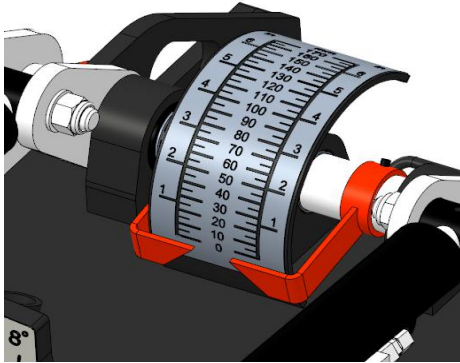

Side swing Angle ruler: through the side swing pointer, you can see the Angle of the milling drum side swing.

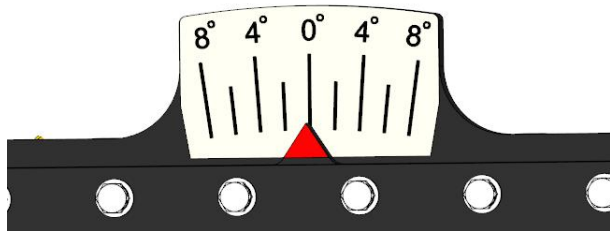

(1) Specific operation steps:

① Equipment capability description:

This type is used for milling asphalt or concrete ground (need to change the milling blade head), can be single milling, multiple milling, side by side milling and other occasions.

② It is important to note that: milling machine milling plane drum rotation direction is single direction, if the milling machine oil pipe connection is correct, however, milling plane drum running, first need to check whether there is a hydraulic oil supply, if there is supply need to change the tubing joint position (change the main tubing joint, to close the host engine) or the opposite direction of oil supply;

③ After opening the hydraulic motor, and gradually increase the flow to improve the speed required for the work, to ensure that in the whole flow adjustment process, the speed change of the milling drum is relaxed;

④ When adjusting the milling depth, first of all, to ensure that the milling drum is in the working state, adjust the left or right side support plate separately, check the logo, a single adjustment control within 3cm. Adjust the other side of the support plate again, adjust to the same depth. If the milling depth is deep, the above operation can be repeated until the desired depth is reached.

⑤ When the main engine is pushing forward, the speed should not be too fast, and the increase speed of the milling depth should also be reduced, so as to avoid the system shutdown, thus damaging the equipment.

(1) Operation method of the control box

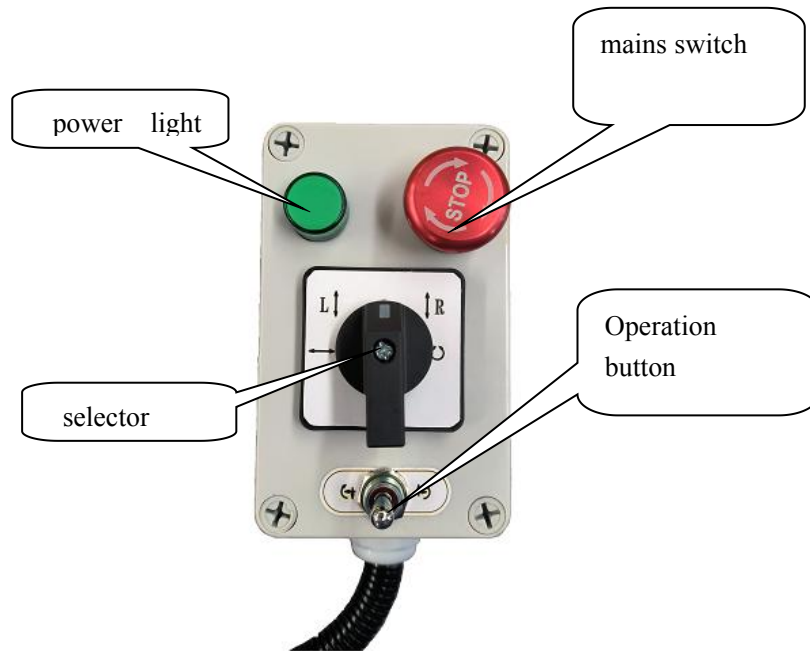

① function Introduction

mains switch: For the power switch of the equipment control box, when the power switch is pressed, the rest of the buttons are powered only to work properly.

power light : When the control box is energized, the indicator light is on when the power switch is pressed, and if not.

selector : The selection button has five gears, and the middle gear is the norm interlunation. Clockwise order is: left and right side movement, left support plate, neutral, Right support plate, shun backward floating.

Operation button : In coordination with the selection button, when the

selection button is adjusted to the left and right side, the swing fluctuation switch controls the milling machine to move left and right; when the selection button is adjusted to the left support plate, the swing button controls the left support plate to move up and down; when the button is selected to adjust to the right support plate, the swing button is controlled to move up and down;

When the selection button is adjusted to the forward inverse float, the swing operation button controls the milling The planer floats clockwise or counterclockwise;

② Connection of the control box

The wiring harness connection

Connect the host end control box harness with the host end control harness; first, align the upper grooves to insert each other and rotate the nut to ensure the aviation plug is locked .



Control harness aviation plug

ed.

(1)Control the power

The wiring harness of the host end comes with a cigarette lighter plug, which can be directly connected to the host cigarette lighter for power supply.



The cigarette lighter plug

- (1) The host engine comes with the aviation plug control

Customers can control the aviation plug on the sliding loader, and they need to provide the manufacturer and model of the sliding loader for customization. At work, the operator only needs to control the button on the handle to control the device.

- (2) maintenance instruction

Regular maintenance is the key to keep the long life and safe work of the machine. The maintenance items described below are more important.

- (1) Check whether all fasteners are loose and tighten them in time;
- (2) Check whether the parts on the equipment are damaged, the solder joints are cracks, and repair them if necessary;
- (3) Regularly add lubricating oil to the hydraulic cylinder and guide rail, generally not more than 40 hours added once.
- (4) After the completion of an operation to timely clean up the milling drum

and other parts of the machine debris and dirt;

- (5) Regularly check the milling cutter, manually turn the milling blade, when the rotation is difficult or motionless, it is necessary to clean up or replace the milling cutter in time, to prevent the milling cutter unilateral wear caused by too fast damage.

- (6) During the maintenance work, we must close the host engine,

Hang a warning sign with "in repair" on the obvious position of the host to prevent others from approaching;

- (7) When the parts need to be replaced, only the parts approved by the manufacturer can be replaced.

- (8) Check the hydraulic system of the machine, whether there is leakage phenomenon, if there is to replace the leaked oil pipe joint or oil pipe in time;

5. Storage instructions

- (1) After the completion of the operation, all the debris, dirt and grease on the machine should be removed;
- (2) The machine shall be stored in a dry and non-corrosive environment to avoid corrosion of the machine surface;
- (3) When the machine is placed, there should be a fixed positioning bracket, so that the next time, convenient connection with the host.
- (4) When unplugging the hydraulic quick connector, you need to cover it with the dust cap Dust contamination.
- (5) The electrical wiring harness needs to be arranged, and the plug needs to be protected.